

DATE	
BY	
SURVEYED	
PLOTTED	
PHOTO. INTERP.	
CHECKED	
MOSAIC	
DATE OF PHOTOGRAPHY	

DATE	
BY	
DETAIL	
REVISIONS	
No.	

DATE	
BY	
DETAIL	
REVISIONS	
No.	

DATE	
BY	
SURVEYED	
SODS PLOTTED	
DESIGN PLOTTED	
PROFILE	
FIELD BOOK NO.	

FRAC. S.1/2 SEC. 14-33-29-4

LOT 2  
BLOCK 1  
PLAN 021 2541

TOWNSHIP ROAD 33-2

LEFT SOD LINE  
OFFSET 10.0m

CP 3  
5,745,730.846  
706,860.526  
984.866

CP 2  
5,745,732.587  
707,129.875  
987.938

FRAC. N.1/2 SEC. 11-33-29-4

UNDEVELOPED  
GOVERNMENT  
ROAD ALLOWANCE

N.W. 1/4 SEC. 12-33-29-4

SITE PLAN

24X36 H=1:750  
11X17 H=1:1500

FRAC. S.1/2 SEC. 14-33-29-4

LOT 2  
BLOCK 1  
PLAN 021 2541

TOWNSHIP ROAD 33-2

FRAC. N.1/2 SEC. 11-33-29-4

UNDEVELOPED GOVERNMENT  
ROAD ALLOWANCE

N.W. 1/4 SEC. 12-33-29-4

HORIZONTAL ALIGNMENT

24X36 H=1:2500  
11X17 H=1:5000

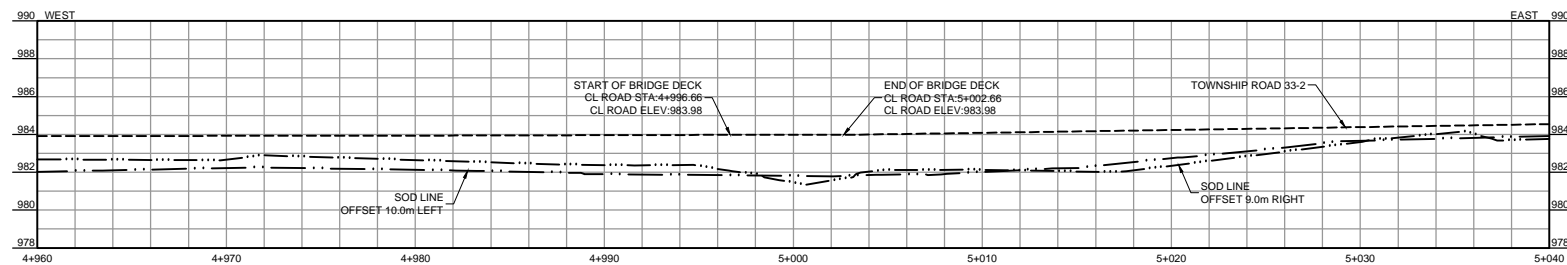
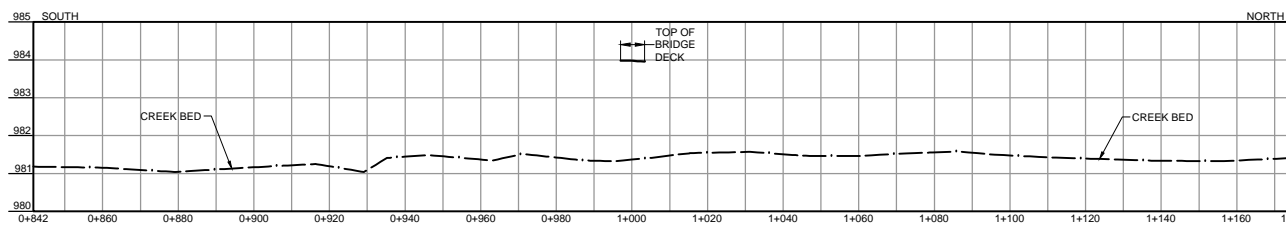

NOTES

1. STATIONING IS ASSUMED AND IS NOTED FOR REFERENCING TO PROFILES AND SECTIONS SHOWN ON THESE PLANS.
2. UTM NAD83 GRID COORDINATES ARE BASED ON ASCM 70672.
3. TO SCALE TO GROUND, USE A COMBINED SCALE FACTOR OF 0.999970.
4. ELEVATIONS ARE GEODETIC BASED ON ASCM 70672.
5. DISTANCES ARE EXPRESSED AS METERS AND DECIMALS THEREOF.
6. THIS IS NOT A LEGAL SURVEY AND SHOULD BE USED FOR INFORMATION PURPOSES ONLY.
7. BACKGROUND LEGAL LINEWORK SHOULD BE USED AS A VISUAL AID ONLY.
8. SURVEYED BY JB & KH ON JULY 25th, 2014.

LEGEND

- MAJOR CONTOUR (5.0m)
- MINOR CONTOUR (1.0m)
- PROPERTY LINE
- RIVER BED
- CENTERLINE ROAD
- SHOULDER LINE
- TOE LINE
- WATER LEVEL LINE (JULY 25th, 2014)
- BARBWIRE FENCE LINE
- ELECTRIC FENCE LINE
- TREE LINE
- OVERHEAD POWER LINE
- POWER POLE
- GRAVEL ROAD
- CONCRETE BRIDGE DECK

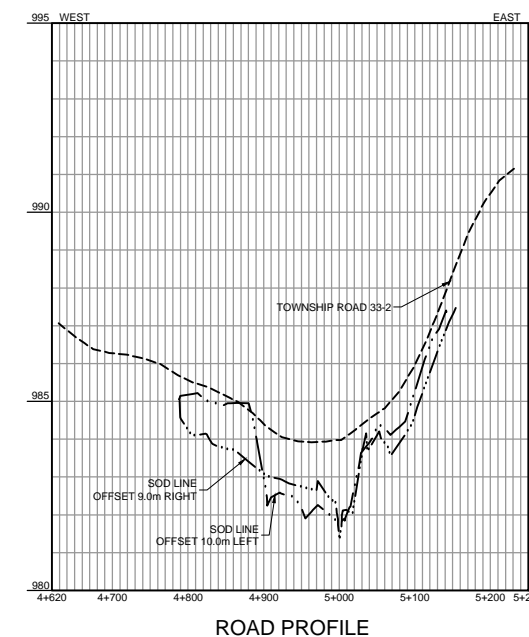

MOUNTAIN VIEW  
COUNTY

Roseke  
Engineering

MIKE SPENCER  
GEOMETRICS

PRELIMINARY SURVEY  
TOWNSHIP ROAD 33-2 OVER CREEK (BRIDGE #2181)  
MOUNTAIN VIEW COUNTY ALBERTA - TOWNSHIP 33, RANGE 29, W4M

No.	REVISIONS	BY	DATE

SURVEYED	DATE	DRAWN	DATE	STREAM	LOCATION	ROAD	FILE	SHEET
J.B. & K.H.	JULY 25/14	K.DOLL	AUGUST 12/14		TWP33, RG29, W4M	TOWNSHIP RD 33-2		1 OF 2

